



Features

- System-kit for sensors measuring speed and direction
- Economic realization of individual sensor solutions
- High flexibility also for smaller volumes
- Interface via connector or wire leads
- Wire orientation front facing or angular bent
- Angular position (wires/connector) of choice
- Variable mounting socket
- Immersion protection min. IP67

Applications

- Electric drives (stationary and mobile)
- Automation systems
- Conveyor belts
- Wind turbines

Technical Data

Measurement Range	0+ to +/- 20 kHz 0+ to +/- 20.000 rpm @ 60 teeth
Air Gap	0 – 2.5mm (depending on target)
Target	Steel (Tooth/Slot)
Tolerance	
Overall Accuracy	+/- 1% FS
Repeatability (Jitter)	+/- 0.1% FS
Temperature	
Permanent	-40°C – 140°C
Short Time	-40°C – 150°C
Supply/Output	
Supply Voltage	4.5 V – 36 V
Current	13 mA (depending on Pull-Up)
Output Signal	Open Collector, Current, PWM, Bus
Output Interface	2-Wire, 3-Wire, 4-Wire
Fall-/Rise-Time	1 ms/10 ms
Protection	
Overvoltage	36 V
Reverse Voltage	36 V
Housing geometry	
Diameter	starting from 12mm
Length	starting from 20mm

Dimensions in mm

Example connector version

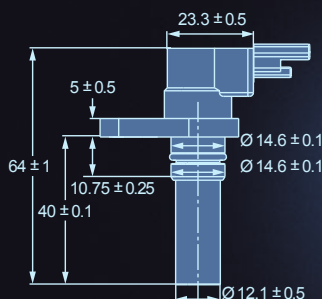

Example wire lead version

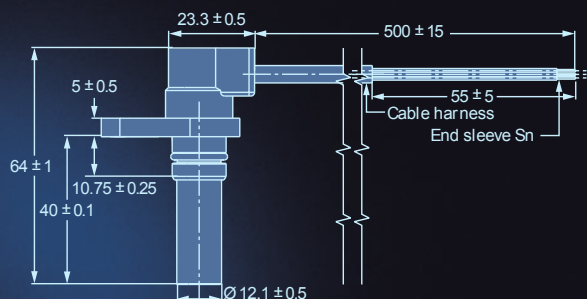

Maximum sensor version

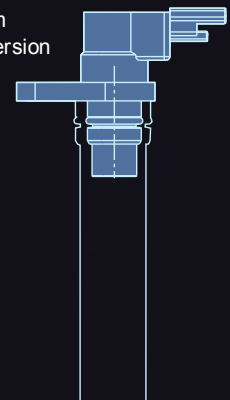

Innovision

GF-12, Goyal Complex, Nr. Sandesh Press, Vastrapur
Ahmedabad 380054
Ph : 079 40034067 9327004067

CHERRY